

Karta mieszkania nr **54** Fijewo 85C, gm. Lubawa

III PIĘTRO

| | | |
|------|-----------------|----------------------------|
| 54/1 | PRZEDPOKÓJ | 5,19 m ² |
| 54/2 | ŁAZIENKA | 4,66 m ² |
| 54/3 | POKÓJ | 10,56 m ² |
| 54/4 | SALON Z ANEKSEM | 23,79 m ² |
| | RAZEM | 44,20 m² |

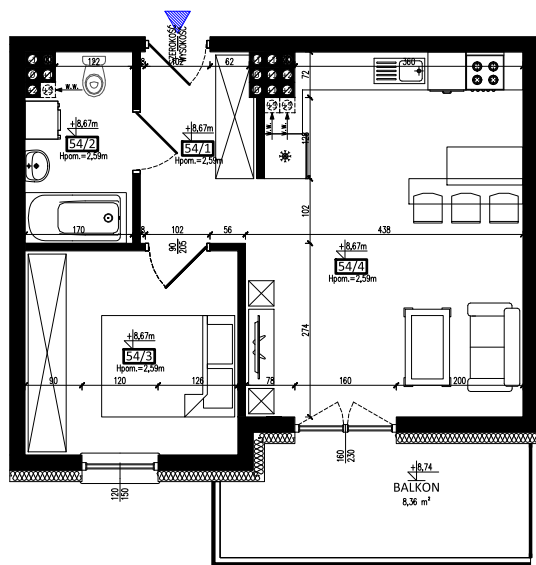
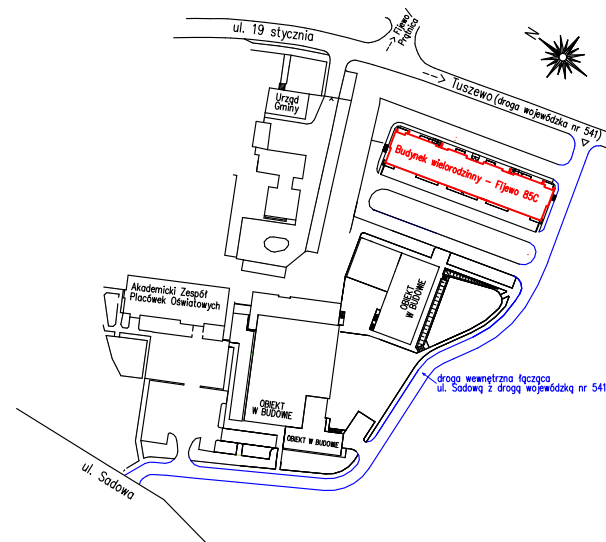

Wizualizacja

